

| You are in: [Lozier Products](#) > [Products](#) > [Leveler T-Leg](#)

# Leveler T-Leg

Part Number: **Part Number: TLEG**

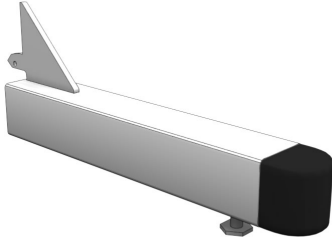

Convert your Wall or Island Gondola into a no-deck unit with T-Legs. Will work on any run length.

## Product Details:

- Converts Display Shelving Wall or Island into a no-deck unit
- Leveler T-Legs install on any length Wall or Island run
- Caster T-Legs available for run lengths up to 12' long (3' & 4' combinations)
- Consists of 2" sq. tubular T-Leg with leveler or caster

## Product Options and Numbers

---

Example Part #: **TLEG 16 PLT XH5**

Type: **TLEG**

Depth: 13", **16"**, 19", 22"

Leg Finish: **PLT**, Optional Catalog Colors

Cap Finish: **XH5**

**Suffix Key**

- PLT** - Platinum
- XH5** - Black Plastic Cap

**Wall Run (Leveler Sections Only)**

<b>T-Leg Depth</b>	<b>Max. Upright Height</b>
13"	66"
16"	84"
19"	96"
22"	120"

For Islands, any combination of Leveler T-Legs can be used with any Lozier Upright.