

| You are in: Lozier Products > Products > Island Section (Wiregrid Backs Both Sides)

Island Section (Wiregrid Backs Both Sides)

Part Number:

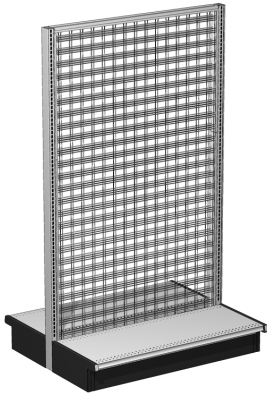

Product Details:

Standard Duty- Load Rating

- Low Base -15,000 inch lbs unbalanced
- 06 Base- 12,000 inch lbs unbalanced

Heavy Duty- Load Rating

- Low Base -18,000 inch lbs unbalanced
- 06 Base- 20,000 inch lbs unbalanced

- Grid retainers and Retainer Backs are used to add any combination of single, double, or triple back set to a wall or gondola section.
- The respective single, double, or triple back retainers are detailed in the Wire Grid Back Retainer Chart.
- RBE_ style grid or hardboard backs can be used interchangeably in any of the grid retainer styles/postions.

DIMENSIONS



- 96"
- 90"
- 84"
- 78"
- 72"
- 66"
- 60"
- 54"
- 48"
- 42"
- 36"

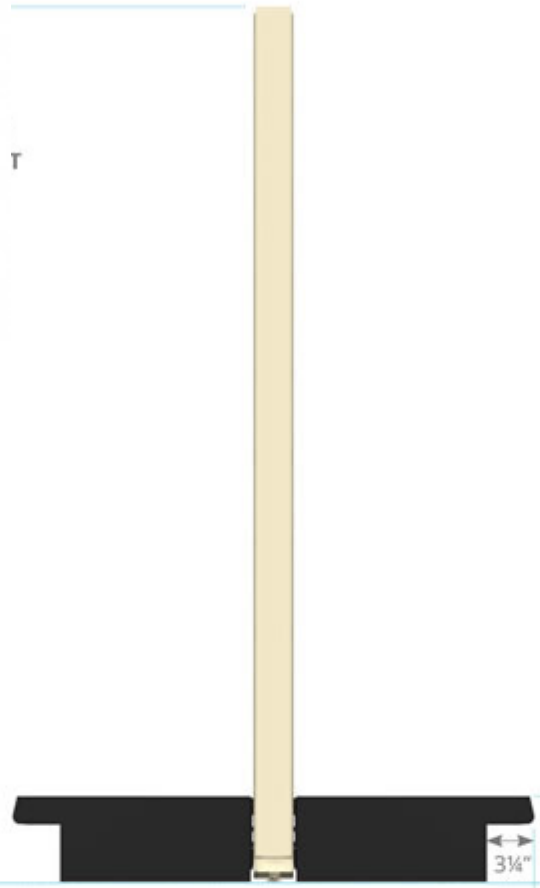

BASE HEIGHT
 STANDARD "06" BASE = 8"
 LOW BASE = 6"

UPRITE DEPTH
 STANDARD UPRITE = 2 1/2"
 HEAVY DUTY UPRITE = 2 7/8"

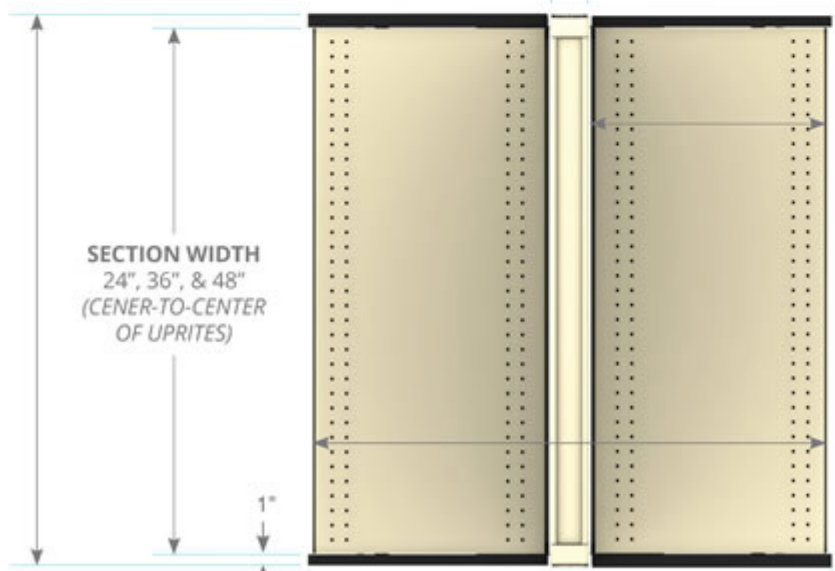

DECK DEPTH
 13", 16", 19", 22", 25", 28" & 31"
 TOP-USABLE-SURFACE OF DECK IS 1/2" LESS THAN DECK DEPTH.

SECTION WIDTH
 24", 36", & 48"
 (CENTER-TO-CENTER OF UPRITES)

SECTION DEPTH
 DECK DEPTH + UPRITE DEPTH + DECK DEPTH
 EXAMPLE SD: 16" + 2 1/2" + 16" = 34 1/2"
 EXAMPLE HD: 16" + 2 7/8" + 16" = 34 7/8"

OVERALL WIDTH
 TOTAL OF SECTION WIDTH(S) + 2"

OVERALL DEPTH
 DECK DEPTH + UPRITE DEPTH + DECK DEPTH + 1 1/4"
 EXAMPLE SD: 16" + 2 1/2" + 16" + 1 1/4" = 35 3/4"
 EXAMPLE HD: 16" + 2 7/8" + 16" + 1 1/4" = 36 1/8"