

| You are in: [Lozier Products](#) > [Products](#) > [Wall End Displays](#)

# Wall End Displays

Part Number:

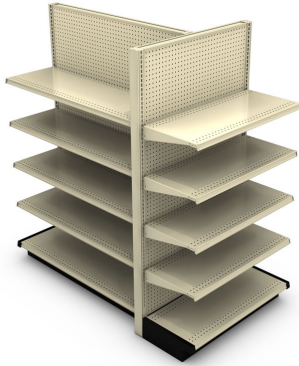

Wall End Display creates a promotional opportunity at the end of an Island run. Customize your display with various Back styles and accessories.

## Product Details:

### Load Rating

- 600 lbs evenly distributed per deck (13" - 19" D)
- 800 lbs evenly distributed per deck (22 - 25" D)

- Freestanding End Display
- Pegboard Front Panel and Martek Back Panel, other Back Panel styles available
- Order Shelves separately
- Order Gap Filler to close off the bottom rear when unit is wider than the island width.
- Actual width of unit equals nominal width plus 2"
- Accepts Accessory Panels and connectors
- Stabilizers required and ordered separately for Non-Compliant height to depth Wall End Displays (See Product Safety information for Height to Depth Chart)

## How to Order

---



22"									
25"									

## Uprite

- 3/16" thick face channel
- 1" slotted on center for maximum flexibility
- Use for Wall and Island Sections
- Steel welded construction
- Includes side flanges to retain Back material, leveling leg for uneven floors
- Includes Top Caps on Uprites 36"-66"H

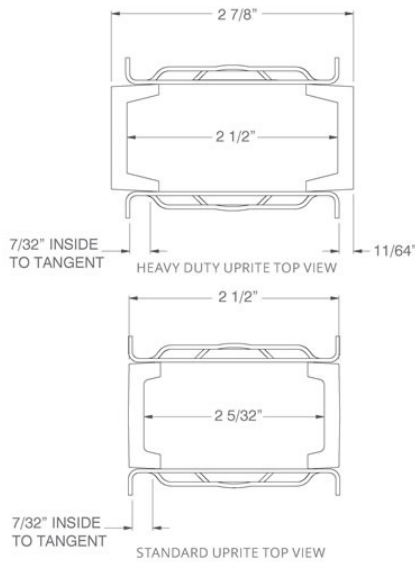

## Product Options and Numbers

Example Part #: **U 42 PLT**

Uprite: **U**, UH

**U Height:** 30", 36", **42"**, 48", 54", 60", 66", 72", 78", 84", 90", 96", 102", 108", 114", 120"

**UH Height:** 72", 78", 84", 90", 96", 108", 120"

Standard Finish: **PLT**, Optional Catalog Colors

Suffix Key	
<b>PLT</b>	- Platinum
<b>U</b>	- Uprite
<b>UH</b>	- Heavy Duty Uprite

## Spring Locking Base Bracket

- Features 2" conduit hole for greater electrical access
- Includes leveling legs for uneven flooring
- Install straight-in using integral spring latch
- Actual Bracket length is 3" less than nominal Deck depth

\*Note: All 28" deep and 31" deep Base Brackets are rated for Heavy Duty capacity, and can be used for both Standard Duty and Heavy Duty applications.

**SYSTEM CAPACITIES ARE LIMITED BY THE UPRITE. FOR HEAVY DUTY CAPACITY, HEAVY DUTY BASE BRACKETS MUST BE USED WITH HEAVY DUTY UPRITES.**



### Product Options and Numbers

**06 Base Bracket, Standard Duty: **BB\_06S****

**Deck Depth:** 13", 16", **19"**, 22", 25", \*28", \*31"

**Standard Finish:** **CHR**

**Example Part #:** **BB 19 06S CHR**

**06 Base Bracket, Heavy Duty: **BBH\_06S****

**Deck Depth:** **22"**, 25"

**Standard Finish:** **CHR**

**Example Part #:** **BBH 22 06S CHR**

**Low Base Bracket, Standard Duty/Heavy Duty: **BBU\_LBSPK10****

**Deck Depth:** 13", 16", **19"**, 22", 25"

Standard Finish: **CHR**

Example Part #: **BBU 19 LBSPK10 CHR**

Low Base Bracket, Standard Duty/Heavy Duty: **BB\_LBS**

Deck Depth: \***28"**, \*31"

Standard Finish: **CHR**

Example Part #: **BB 28 LBS CHR**

Suffix Key	
<b>06</b>	- 06 Base (8"H)
<b>LB</b>	- Low Base (6"H)
<b>CHR</b>	- Charcoal Black

## SD Deck

---

- Standard Deck style for Island and Wall runs
- Molding accommodates a 1.235" tag
- 1/4" perforations for clip-on accessories
- Evenly distributed load of 600 lbs (13"-19"D) and 800 lbs (22"-31"D)

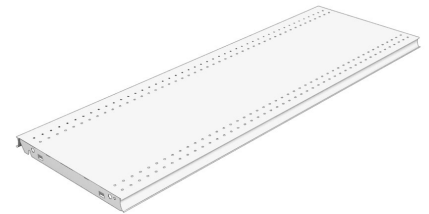

## Product Options and Numbers

Example Part #: **SD 4 16 N PLT**

SD Deck: **SD**

Width: 2', 30", 3', **4'**

Base Depth: 13", **16"**, 19", 22", 25", 28", 31"

No Molding: **N**

Standard Finish: **PLT**, Optional Catalog Colors

Suffix Key	
<b>N</b>	- No Molding

## Closed Base Front

---

- 3' and 4' Fronts have an electrical knockout
- Snaps in place beneath Deck to cover gap between Deck and floor
- Fits flush with floor regardless of leveling adjustments



### Product Options and Numbers

Example Part #: **CBF 4 06 CHR**

Close Base Front:**CBF**

Section Width: 2', 30", 3', 4'

Base Height: **06**, LB

Standard Finish: **CHR**

Suffix Key	
<b>06</b>	- 06 Base (8"H)
<b>LB</b>	- Low Base (6"H)
<b>CHR</b>	- Charcoal Black

## Open Base Front

---

- Use Open Base Front instead of Closed Base Front
- Order CHR Base Brackets when using Open Base Front

### Product Options and Numbers

Example Part #: **OBF 4 06 CHR**



Open Base Front:**OBF**

**Section Width:** 2', 30", 3', 4'

**Base Height:** 06, LB

**Standard Finish:** CHR

Suffix Key	
06	- 06 Base (8"H)
LB	- Low Base (6"H)
CHR	- Charcoal Black

## Top Rail

---

- All Island and Wall Sections require one Top, Center and Bottom Rail
- 2' and 30" sections use two Top Rails to make a Splicer Rail
- Electrical knockouts included on all Rails

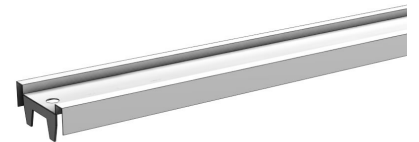

## Product Options and Numbers

Example Part #: R 4 T PLT

**Rails:**R

**Width:** 2', 30", 3', 4'

**Top Rail:** T

**Standard Finish:** PLT,Optional Catalog Colors

Suffix Key	
PLT	- Platinum Color

## Center Rail

---

- All Island and Wall Sections require one Top, Center and Bottom Rail
- 96”H-144”H Backs require two Center Rails
- Center Rail finish is always N/A because it's hidden
- Electrical knockouts included on all Rails

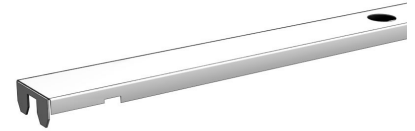

## Product Options and Numbers

Example Part #: **R 4 C N/A**

**Rails:**R

**Width:** 2', 30", 3', 4'

**Center Rail:** C

**Standard Finish:** N/A

## Bottom Rail

---

- All Island and Wall Sections require one Top, Center and Bottom Rail
- Electrical knockouts included on all Rails
- Also used for 2' and 30" Slotwall Backs

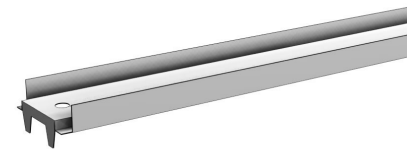

## Product Options and Numbers

Example Part #: **R 4 B PLT**

**Rails:**R

**Width:** 2', 30", 3', 4'

**Bottom Rail:** B

**Standard Finish:** PLT,Optional Catalog Colors

### Suffix Key

PLT

- Platinum Color



## Splicer Rail

---

- All Island and Wall Sections require one Top, Center and Bottom Rail
- 78"H - 144"H Backs require one Splicer Rail
- Splicer rail is not available in 2' or 30"
- Use two top rails for splicer rail on 2' and 30" wide sections.
- Electrical knockouts included on all Rails

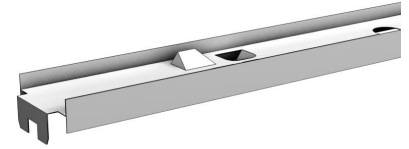

## Product Options and Numbers

Example Part #: **R 4 S PLT**

**Rails:**R

**Width:** 3', 4'

**Splicer Rail:** S

**Standard Finish:** PLT,Optional Catalog Colors

### Suffix Key

PLT - Platinum Color

## Hardboard Backs

---

- Use one-piece Backs for heights 36"-72"
- For heights above 72" order 2 backs, see table below
- Pegboard 9/32" diameter holes, 1" on center
- To order the correct size Back, take Upright height minus 6

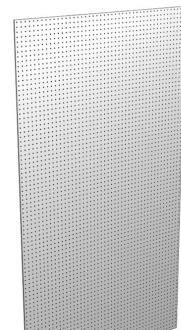

## Product Options and Numbers

Section Heights: 78"-120"  
Use 2-Piece Backs

Upright Height	Order Backs
78"	BE_36 + BE_36

84"	BE_30 + BE_48
90"	BE_36 + BE_48
96"	BE_42 + BE_48
102"	BE_66 + BE_30
108"	BE_66 + BE_36
114"	BE_66 + BE_42
120"	BE_66 + BE_48

**Actual Back Height Information**

<b>Upright Height</b>	<b>Nominal Back Height</b>	<b>Actual Height</b>
30"	24"	23 13/16"
36"	30"	29 13/16"
42"	36"	35 13/16"
48"	42"	41 13/16"
54"	48"	47 13/16"
60"	54"	53 13/16"
66"	60"	59 13/16"
72"	66"	65 13/16"

**Actual Width Information**

<b>Nominal Width</b>	<b>Actual Width</b>
6"	4 17/32"
12"	10 17/32"
16"	14 17/32"
18"	16 17/32"
24"	22 17/32"
30"	28 17/32"
32"	30 17/32"
36"	34 17/32"
42"	40 17/32"
48"	46 17/32"

**Actual Back Height for Extension Upright**

<b>Upright Height</b>	<b>Actual Height</b>
6"	5 13/16"
12"	11 13/16"

18"	17 13/16"
24"	23 13/16"
30"	29 13/16"
36"	35 13/16"
42"	41 13/16"
48"	47 13/16"

## Base End Trim

---

- Attaches to the first and last Base Bracket in a run
- Comes in a pair
- One pair is required to finish a Wall run
- Two pairs are required to finish an Island run



## Product Options and Numbers

Example Part #: **BET 13 06 CHR**

Base End Trim: **BET**

Deck Depth: **13"**, 16", 19", 22", 25", 28", 31"

Base Height: **06**, LB

Standard Finish: **CHR**

Suffix Key	
<b>06</b>	- 06 Base (8"H)
<b>LB</b>	- Low Base (6"H)
<b>CHR</b>	- Charcoal Black

## Upright and Extension Upright End Trim

---

- One-piece trim (Two-pieces if 102"-144"H) snaps onto first and last Uprite o
- Can be used on both sides of Extension Uprites where Extension Backs are



## Product Options and Numbers

Example Part #: **UET 48 PLT**

Uprite/Extension Uprite End Trim: **UET**

Height: 6", 12", 18", 24", 30", 36", 42", **48"**, 54", 60", 66", 72", 78", 84", 90", 96", 102", 108", 114", 120"

Standard Finish: **PLT**, Optional Catalog Colors

Suffix Key	
PLT	- Platinum

## Wall End Display Stabilizer

- Anchors freestanding 2', 30", 3', or 4'W Wall End Display to 3' or 4' Island S
- Accommodates up to 9" offset (3" increments)
- Required when a Wall End Display or Contoured End Display has an unacc height-to-depth ratio (Levelers exceed 6:1)
- Wall End and Gondola End Section Top Rail not required
- Stabilizes top of WEDNB (No Base End Cap)



### COMPONENTS (ORDERED SEPARATELY):

- Wall End Display End Top Rail (WEDER)
- Wall End Display Gondola Top Rail (WEDGR)

## Product Options and Numbers